

UNIT E

1,631 square feet
3 bedrooms
3 baths



S P R I N G
CONDOMINIUMS

INFO@SPRINGAUSTIN.COM
WWW.SPRINGAUSTIN.COM
512.472.8118

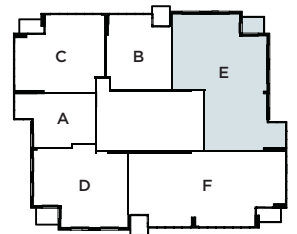
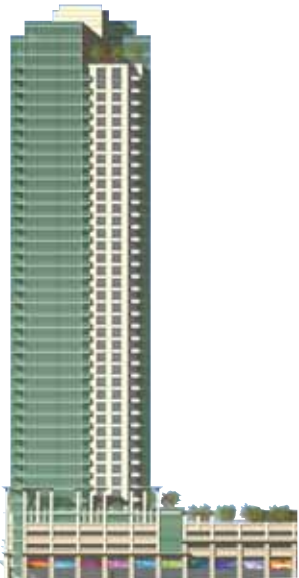

Unit E will be available on floors 24-38 in the floorplate above and on floors 39-41 in the floorplate below.

